



SSV-909X-T Overview

Overview

SSV-909X-T series is thermal human body temperature screening system, which uses Linux system. It supports for multi-channel camera inputs of thermal IPC with the functions of face detection, body temperature capture and recording, abnormal temperature alarm and other functions. It has been mainly used for the detection of abnormal human body temperature in public places with large flow of people.

Features and Functions

- More precise face detection based on deep learning algorithm
- Support visible and thermal dual video simultaneously decode and capture
- Support temperature detection area setting
- Support pedestrian direction setting
- Support blackbody automatic temperature compensation and manual temperature compensation based on time period
- Support abnormal temperature alarm output
- Support visible and thermal video Real-time recording and playback
- Support SSD*1
- Support multi-channel cameras inputs
- HDMI1 output at up to 1920x1080 resolution
- VGA1 output at up to 1920x1080 resolution
- Support multi-device networking, Up to 16-ch thermal camera inputs

Application Scenarios

SSV-909X-T can be used in Airport, Metro, Commercial, School for multi-person temperature screening.

Physical Interface



Stand-alone application



Network application

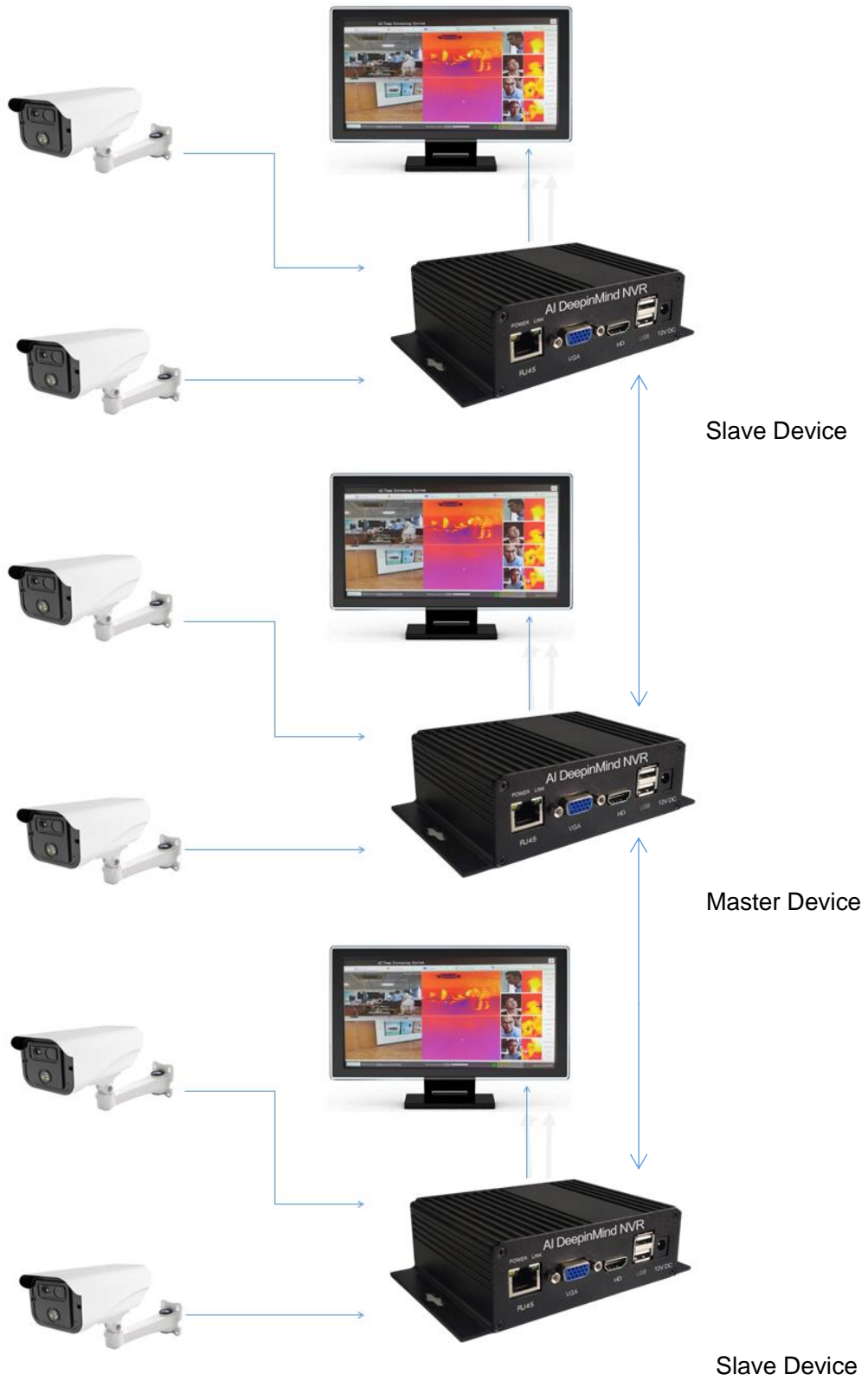

Specification:

| | | | |
|---------------------------|---------------------|----------------------------|------------|
| Model | | SSV-9092-T | SSV-9094-T |
| Decoding | Decoding format | H.265/H.264 | |
| | Capability | 1080P | |
| | Frame rate | PAL 1~25FPS NTSC 1~30FPS | |
| | Stream type | Video Stream | |
| Interface | USB | USB2.0*2 | |
| | Network | 1 RJ-45 Ports (10/100Mbps) | |
| Video/Audio Input | IP Camera Input | 2 | 4 |
| | Input Protocol | HHINF | |
| Video/Audio Output | VGA Output | VGA1:1920x1080 | |
| | HDMI Output | HDMI1: 1920x1080 | |
| Storage | Hard disk | 512GB SSD | 1TB SSD |
| General | Operating | Mouse | |
| | Total power | <10W | |
| | Working temperature | -10 to +55° C | |
| | Working humidity | 0%-90% RH | |
| | Weight | 0.5KG | |
| | Power supply | 12V/DC | |
| | Dimension | 147mm 91mmx42mm | |

Dimensions and Package

